

THIS IS A TWO PAGE PARTS LIST.
 THIS FIRST PAGE APPLIES TO
 MODELS 45-0459-00 & L5-0459-00 AT REVISION B AND LATER REVISIONS.

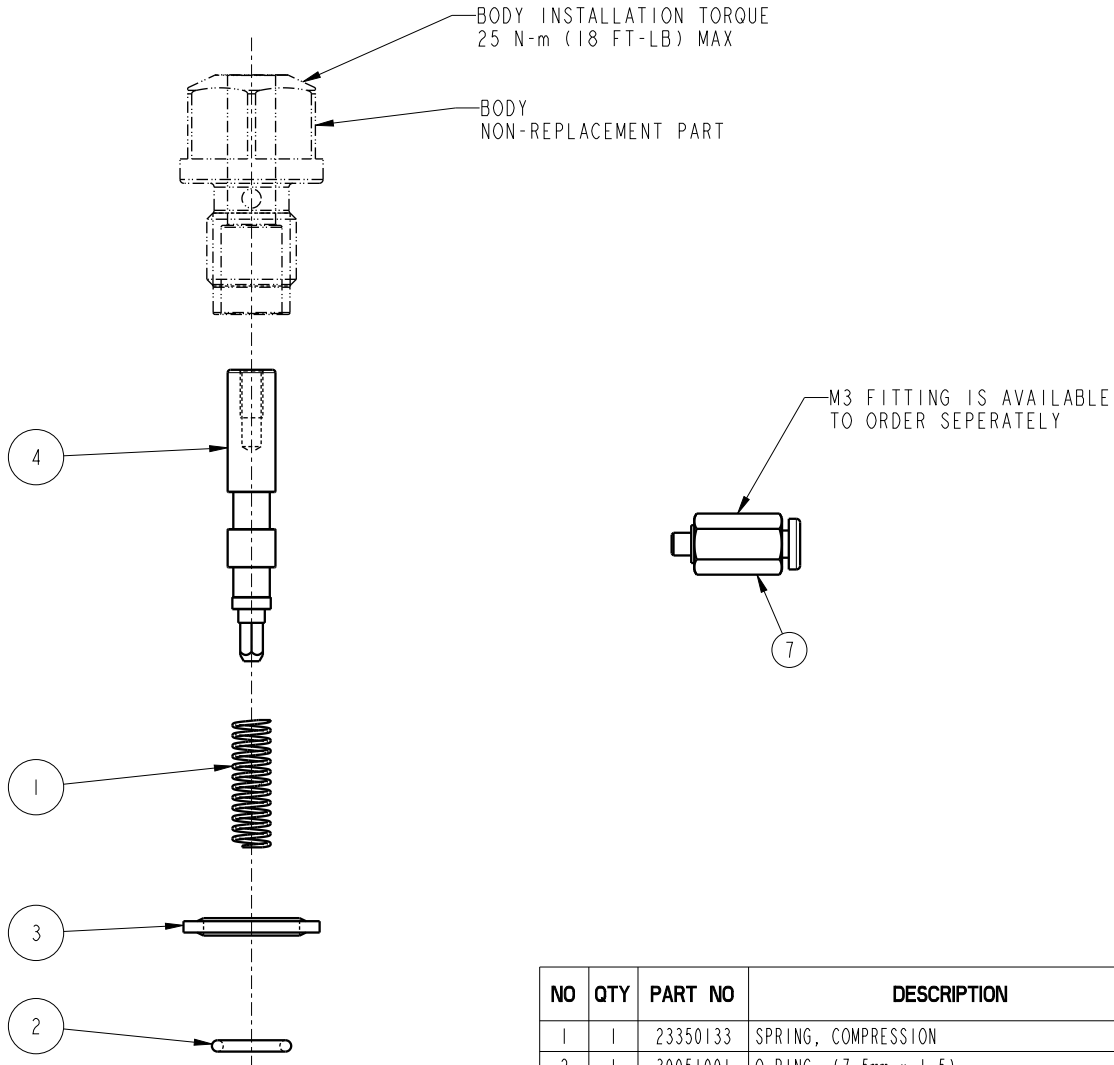

NO	QTY	PART NO	DESCRIPTION	REPAIR KIT
1	1	23350133	SPRING, COMPRESSION	X
2	1	39051091	O-RING, (7.5mm x 1.5)	X
3	1	39055021	SEAL, BONDED, M12	X
4	1	85040003	PISTON, SENSOR, POSITION, PNEU, OCO	
7	N/A	P3037020	1/8 TUBE - M3 CONNECTOR	
N/A	N/A	62504001	KIT, REPAIR	NOTED
N/A	N/A	1S5003	INSTRUCTION SHEET	

PARTS LIST



VEKTEK, INC.
 1334 E. SIXTH AVE. P.O. BOX 625
 EMPORIA, KS. 66801 U.S.A.

ASSEMBLIES AFFECTED
 45049500
 L5049500

PARTS LIST, ASSY, SENSOR, POSITION, PNEU, OCO

SIZE
 A

MPL6905

REV
 C

SHEET 1 OF 2

FORM FEG035_PL_ASIZE, REV. B

C	5164	RELEASE	RLK	8/28/23
REV	IN ACCORDANCE WITH ECN	EFFECTIVE DATE	REVISED BY	DATE
DRW BY: MAJ	DRAWING STATUS: Released			
DATE: 11/11/16	PRODUCTION APPROVED FOR RELEASED STATUS ONLY			

THIS IS A TWO PAGE PARTS LIST.
 THIS SECOND PAGE APPLIES TO
 MODELS 45-0459-00 & L5-0459-00 AT REVISION A.

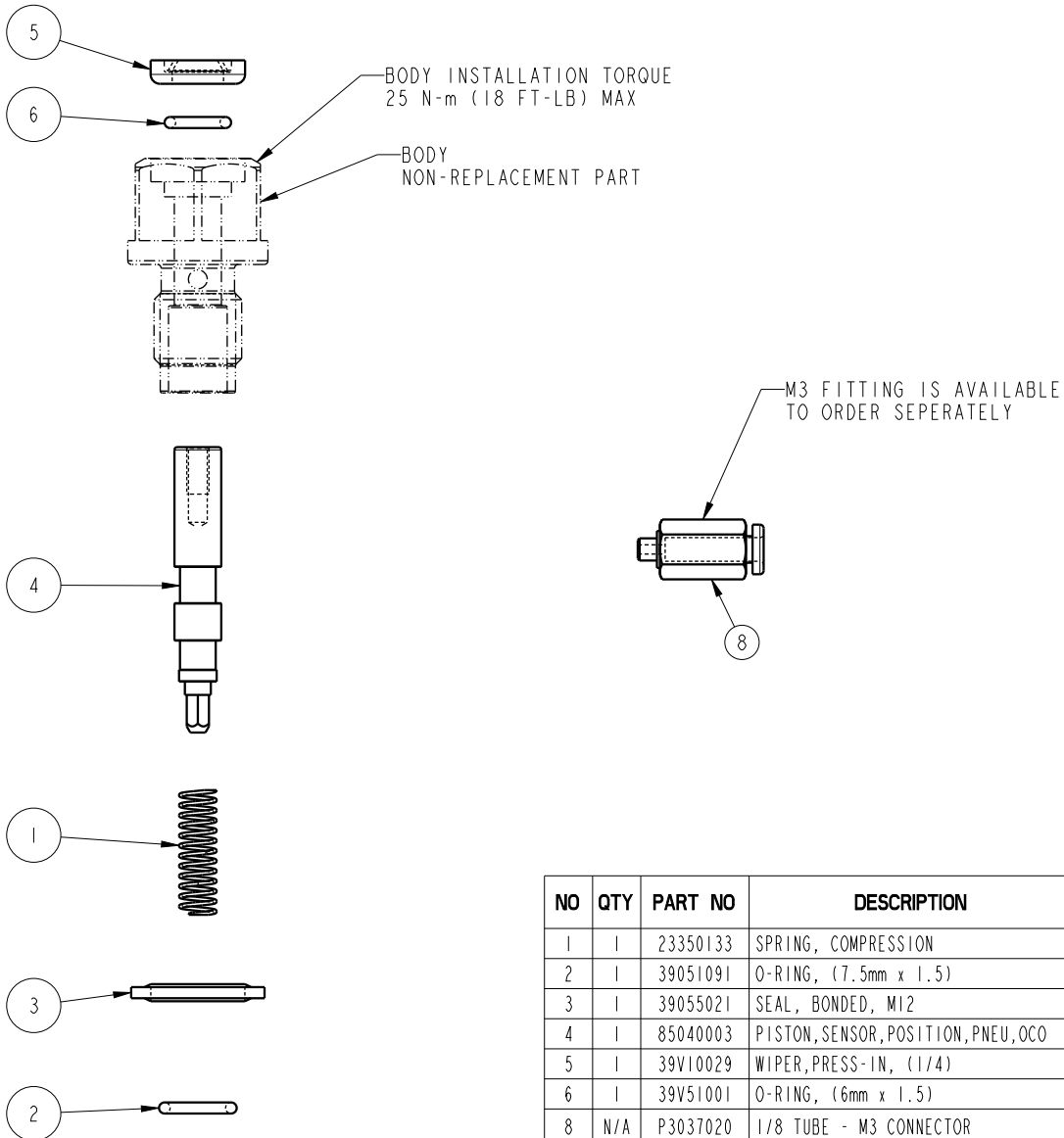

NO	QTY	PART NO	DESCRIPTION	REPAIR KIT
1	1	23350133	SPRING, COMPRESSION	X
2	1	39051091	O-RING, (7.5mm x 1.5)	X
3	1	39055021	SEAL, BONDED, M12	X
4	1	85040003	PISTON, SENSOR, POSITION, PNEU, OCO	
5	1	39V10029	WIPER, PRESS-IN, (1/4)	X
6	1	39V51001	O-RING, (6mm x 1.5)	X
8	N/A	P3037020	1/8 TUBE - M3 CONNECTOR	
N/A	N/A	62504001	KIT, REPAIR	NOTED
N/A	N/A	IS5003	INSTRUCTION SHEET	

PARTS LIST



C	5164	RELEASE	RLK	8/28/23
REV	IN ACCORDANCE WITH ECN	EFFECTIVE DATE	REVISED BY	DATE
DRW BY: MAJ	DRAWING STATUS: Released			
DATE: 11/11/16	PRODUCTION APPROVED FOR RELEASED STATUS ONLY			

ASSEMBLIES AFFECTED
 45049500
 L5049500

PARTS LIST, ASSY, SENSOR, POSITION, PNEU, CART, OCO		
SIZE A	MPL6905	REV C